

| | | | | | |
|----------|------------|-----|--------|----------|-----|
| PART NO. | A44200-051 | REV | ECO | DATE | APP |
| | | A | 103653 | 07-29-17 | TLM |

MATERIAL:

SHELL:
 ALUMINUM 6061-T6,
 NICKEL PLATE (500
 MICROINCHES MINIMUM)
 PER SAE-AMS-2404

HARDWARE:
 303 STAINLESS STEEL PER
 ASTM 582

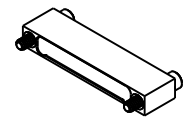

ACTUAL SIZE

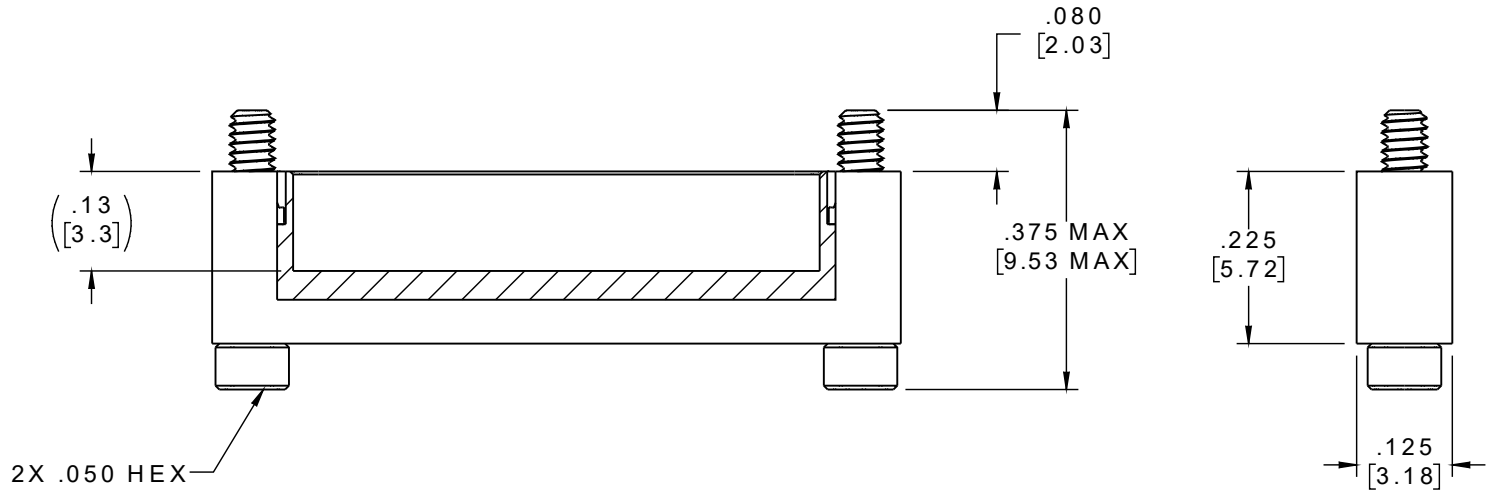
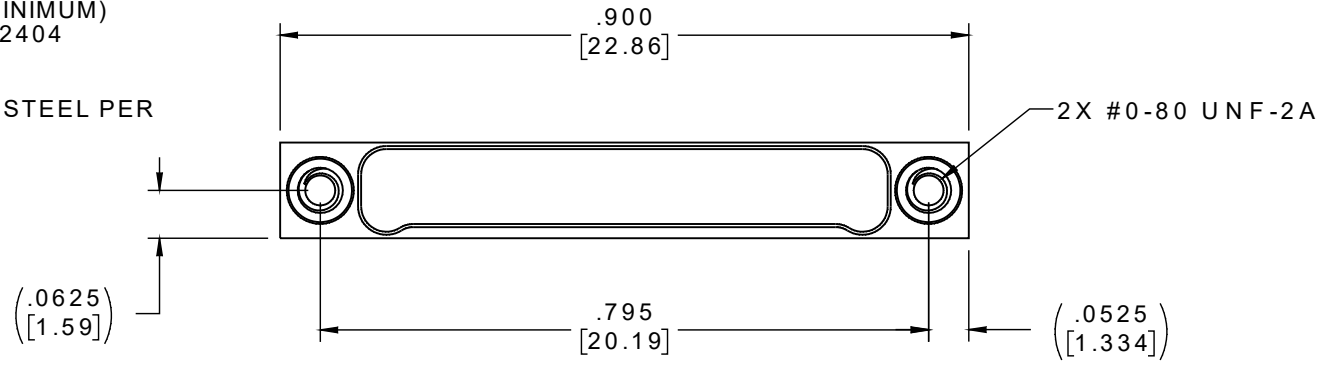

NOTE:

DIMENSIONS IN [] ARE IN MILLIMETERS UNLESS OTHERWISE NOTED AND ARE FOR REFERENCE ONLY

| | | | | | | | |
|-------|------------------------|--|---------------|---|---|--------------------|--|
| ASSTD | THIRD ANGLE | THIS DRAWING CONTAINS CONFIDENTIAL AND PROPRIETARY INFORMATION WHICH IS THE PROPERTY OF OMNETICS CONNECTOR CORP. THIS DOCUMENT MAY NOT, IN WHOLE OR IN PART, BE DUPLICATED, OR DISCLOSED FOR ANY PURPOSE, WITHOUT WRITTEN PERMISSION FROM OMNETICS CONNECTOR CORP. | | OMNETICS CONNECTOR CORPORATION 7260 COMMERCE CIRCLE EAST MINNEAPOLIS, MN 55432 WWW.OMNETICS.COM | CAGE CODE 61873 | | |
| | -TOLERANCES- | DFTM. TLM | DATE 07-10-17 | | TITLE: DUST COVER MALE Bi-Lobe® (51) POSITION | DWG NO. A44200-051 | |
| | UNLESS OTHERWISE NOTED | CHK'D. | DATE | | | SHEET 1 OF 1 REV | |
| | DIMENSIONS IN INCHES | APP'D. | DATE | | | SCALE: 4:1 A | |
| | 2 PL DEC ± .01 | | | | | | |
| | 3 PL DEC ± .005 | | | | | | |
| | 4 PL DEC ± .0005 | | | | | | |
| | ANGLES ± 1° | | | | | | |