

MATERIALS & SPECIFICATIONS

HOUSING:  
ALUMINUM 6061-T6, NICKEL  
PLATE PER SAE-AMS-2404

INSULATOR:  
LIQUID CRYSTAL POLYMER  
(LCP) PER ASTM D5138

CONTACTS:  
COPPER ALLOY PER MIL-DTL-  
32139, GOLD PLATED PER  
ASTM B488, (HARD GOLD)  
TYPE II CODE C, CLASS 1.27

TERMINATION:  
SOLDER COATED WITH SN63A  
PER J-STD-006

CURRENT RATING:  
1 AMP MAX PER MIL-DTL-  
32139

CONTACT RESISTANCE:  
71 MILLIOHM MAX (71mV  
DROP MAX) @ 1.0 AMPS PER  
MIL-DTL-32139

PERFORMANCE:  
PRODUCT FAMILY TESTED TO  
AND PASSED THE  
PERFORMANCE SPECIFICATIONS  
OF TABLE VIII OF MIL-DTL-  
32139

PART NO.	A29900-051	REV	ECO	DATE	APP
		K	102608	05-20-16	TLM

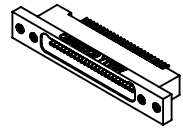
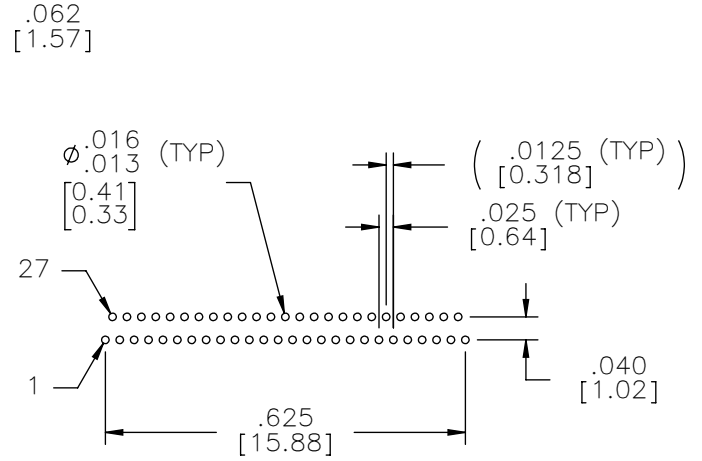
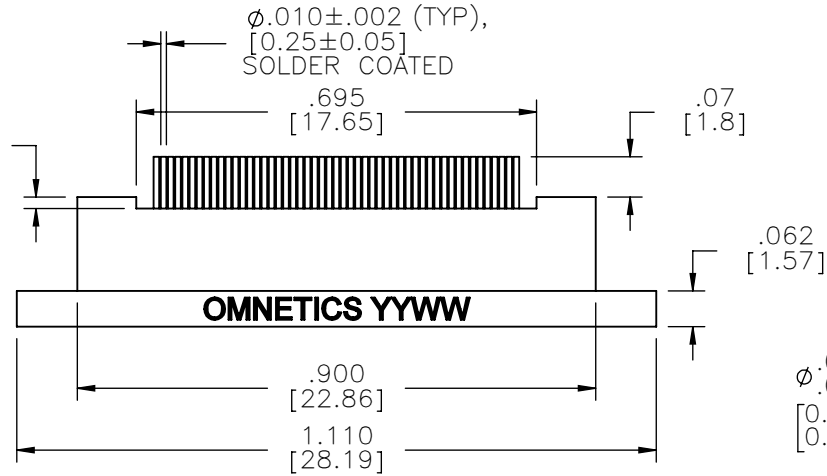

ACTUAL SIZE

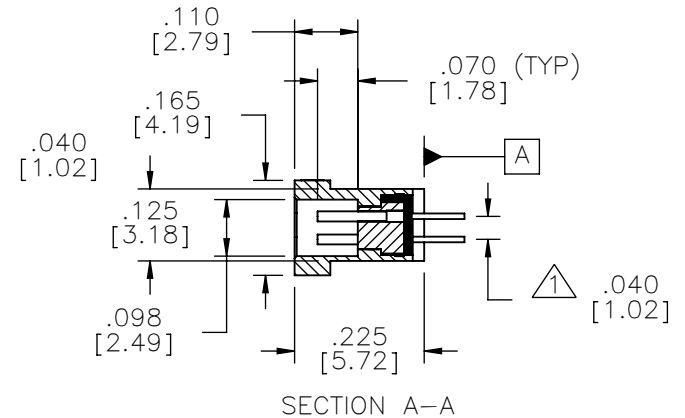
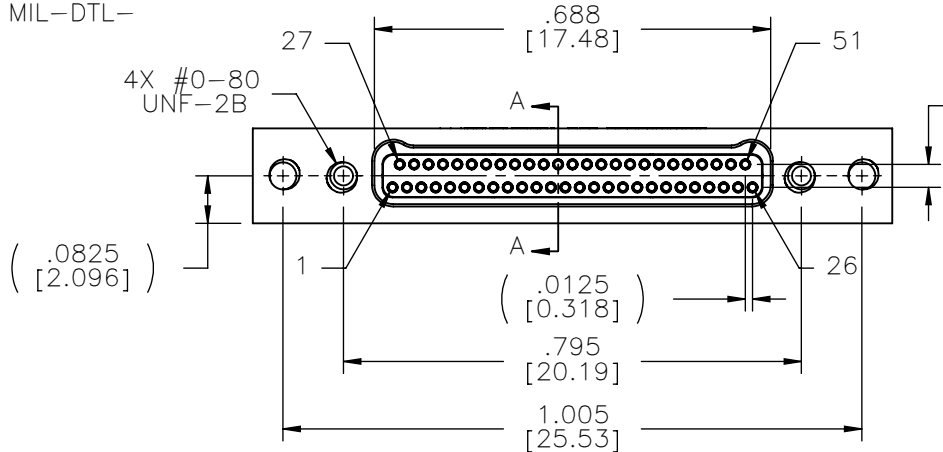

NOTES:  
▲ TAIL DIMENSIONS APPLY  
AT PLANE [A]

DIMENSIONS IN [ ] ARE IN  
MILLIMETERS UNLESS  
OTHERWISE NOTED AND ARE  
FOR REFERENCE ONLY

M S C S	THIRD ANGLE
	-TOLERANCES-
	UNLESS OTHERWISE NOTED
	DIMENSIONS IN INCHES
2	PL DEC ± .01
3	PL DEC ± .005
4	PL DEC ± .0005
	ANGLES ± 1°

THIS DRAWING CONTAINS CONFIDENTIAL AND PROPRIETARY INFORMATION WHICH IS THE PROPERTY OF OMNETICS CONNECTOR CORP. THIS DOCUMENT MAY NOT, IN WHOLE OR IN PART, BE DUPLICATED, OR DISCLOSED FOR ANY PURPOSE, WITHOUT WRITTEN PERMISSION FROM OMNETICS CONNECTOR CORP.	
DFTM. AAS	DATE 05-17-04
CHK'D.	DATE
APP'D.	DATE
TITLE: (51) SOCKET FEMALE Bi-Lobe® CONNECTOR	

**OMNETICS**  
CONNECTOR CORPORATION  
7260 COMMERCE CIRCLE EAST  
MINNEAPOLIS, MN 55432  
WWW.OMNETICS.COM

CAGE CODE 61873	
DWG NO. A29900-051	
SHEET 1 OF 1	REV K
SCALE: 3:1	